

Day/Night Shade Motor User Manual

01 Product Info

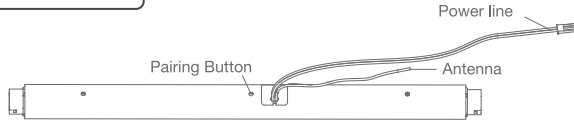

Remote Controller Buttons

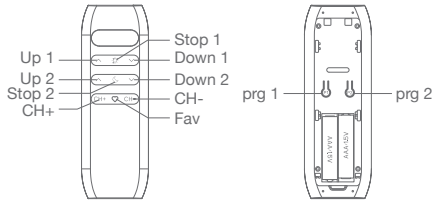

Working temperature



Models & Parameters (more info please refer to the nameplate)

JCV	30	S	AE	D	06	30
AC Motor	30:φ24mm	S: Standard	AE:with adaptor supply (External Wi-Fi/Zigbee optional)	Dual driving	Torque:2'0.6N.m	Speed: 30Rpm

Installation requirements:

It is necessary to ensure that the marking end of the motor Day Shade is connected with the rope winder on the upper end of the Day Shade

02 Power Options

Adapter

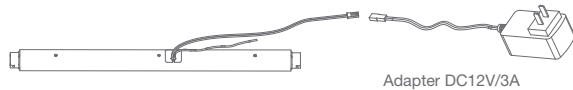

Adapter DC12V/3A

03 Caution!



- 1.This product is for indoor use only, do not use outdoor or in humid environments.
- 2.Power supply: Adapter 12V/3A.
- 3.The motor will jog in operation, please do not proceed to the next step until it complete.
- 4.During operation, the effective interval of the transmitter button operation is 10 seconds.
If there is no effective transmitter operation for more than 10 seconds, it will automatically exit the current mode.
- 5.The motor can be paired with max 10 controllers.
- 6.Upper&Lower limits cannot be set at the same position, limits saved even power off.
- 7.The motor runs constantly for at 6 mins max without any other operation.
- 8.Do not lift the motor by grabbing and pulling the power wire or the antenna.

04 Instructions

Pairing Button functions

Functions	Operation	Jogging time	Note
Control the UP/STOP/DOWN of the shade	Short press	/	It should be used when limits being set
Adding/Removing Controller	Hold for 2s	Jog*1	Operation needs be done within 10s
RF Control Inactive	Hold for 6s	Jog*2	Hold Pairing button for 6s, jog twice to show the motor RF control is inactive; Hold Pairing button for 2s, the RF control is active again.
Direction Reverse	Hold for 10s	Jog*3	All settings saved after direction reversed
Reset	Hold for 16s	Jog*4	All settings deleted

a.Pairing Motor with Controller

Way 1: Power on, add a new controller

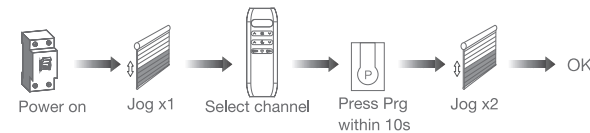

Way 2: After motor is powered on for more than 10s

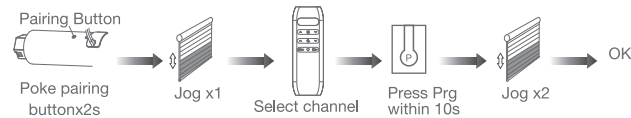

Way 3:Power on,add controller B via pre-existing controller A

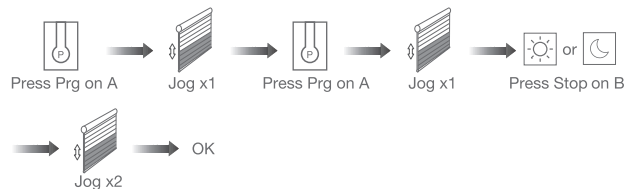

Note: During operation, the effective interval of the remote controller button operation is 10 seconds. If there is no effective remote controller operation for more than 10 seconds, it will automatically exit the pairing mode.
If reconnect the power after poweroff, the motor will jog and enter the pairing mode automatically.
Pairing can not be done under group channel or 0 channel.

b.Direction Reverse

Correct

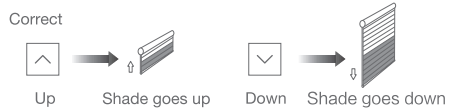

If the limits are not set, and direction goes opposite.

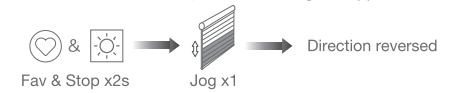

Note: If the motor has a limit, please delete the limit before reversing.
Do reverse the direction when it goes opposite.

c.Upper&Lower Limits Setting

Limits setting sequence:

Day Shade upper limit -- Night Shade upper limit -- Night Shade lower limit -- Day Shade lower limit



Note: Upper&Lower limits cannot be set at the same point.

Before limits set, the motor will run in one-touch mode by pressing Up or Down, hold Up or Down for 2s, motor runs in constant-touch mode.
Once limits set, press Up or Down, motor runs in constant-touch mode.

d. One button to switch modes

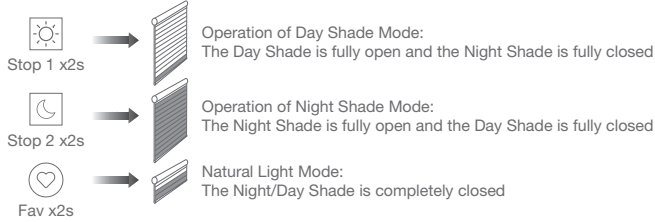

Note: One button to switch modes only can be done after upper&lower limit set.

e. One-touch/Constant-touch Mode

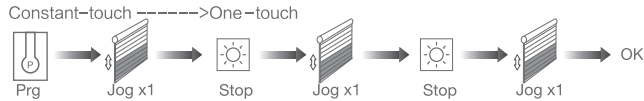

Same operation can toggle from one-touch to constant -touch mode.

Note: When motor in one-touch mode, hold Up or Down for more than 2s, it will run in constant-touch mode.

f. Setting and Cancelling Favorite Position

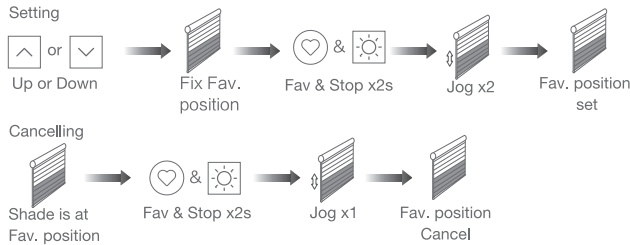

g. Hot key to the Fav. Position

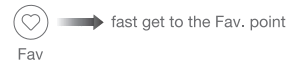

Note: The Fav.position setting only can be done after upper&lower limits set.

h. Shade Percentage Position Settings

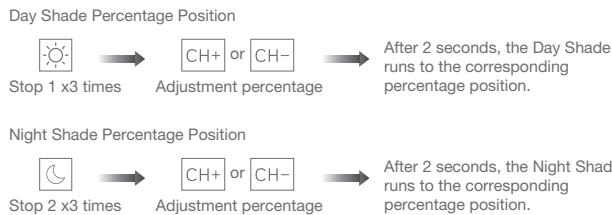

i. Adjusting Upper & Lower Limits

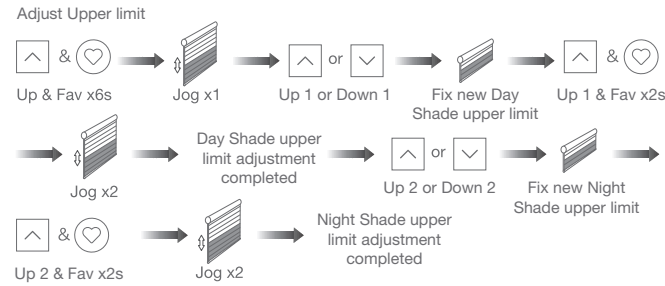

Limit setting sequence: Set the Day Shade upper limit before the Night Shade upper limit.

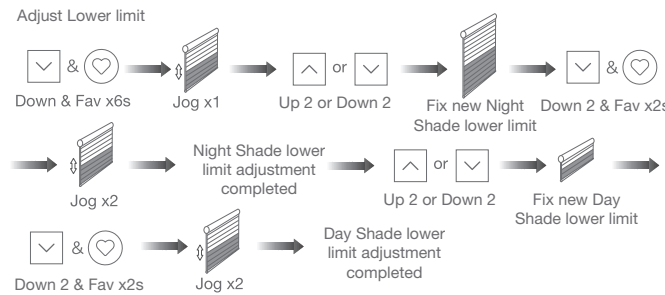

Limit setting sequence: Set the Night Shade lower limit before the Day Shade lower limit.

Note: After adjusting the limits, the position of the original favorite position will remain; If the motor is not operated when adjusting the limits, after the motor stops for more than 4 minutes, it will jog once and automatically exit the adjusting limits mode. If the upper and lower limits are set at the same position, they will be invalid and a new position needs to be set. When adjusting the limits, the reversing operation of the remote controller is invalid. Long press the motor head button for reversing is effective, and exit the adjusting limits mode.

j. Adjusting Motor Speed

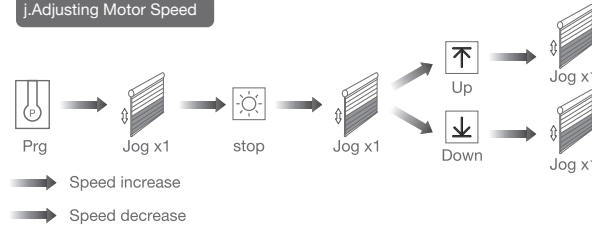

Note: If motor doesn't jog, the max/min speed has already been reached. There are 3 speeds adjustable.

k. Removing Controllers

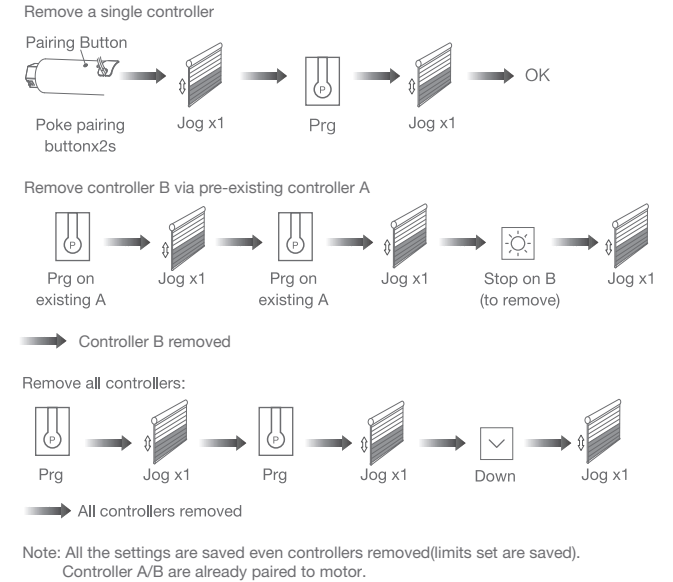

l. Cancelling Limits

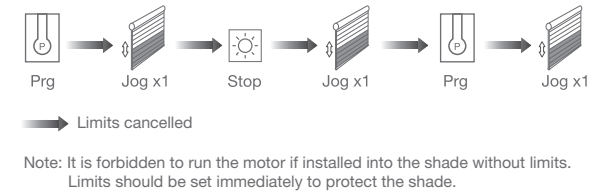

05 Troubleshooting

Fault	Cause	Solution
Motor does not work	1.Controller not paired 2.Motor inactive	1.Add controller 2.Poke Pairing button x2s to activate motor
Motor stops suddenly	1.Upper & Lower limit set incorrectly 2.Shade exceed rated load	1.Re-set Upper & Lower limits 2.Adjust load
Motor just goes in one direction	Wrong limits set	Cancel original limits, set new limits