

JCHR35W3C3/C4/C5

Hand-held LCD Remote Controller

User Manual

01 Product Info

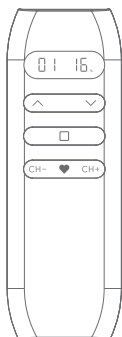

JCHR35W3C3
Application:Roller shade

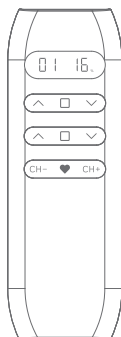

JCHR35W3C4
Application:Roller shade

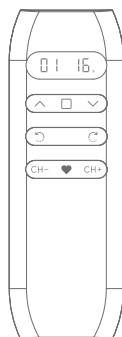

JCHR35W3C5
Application:Venetian blind

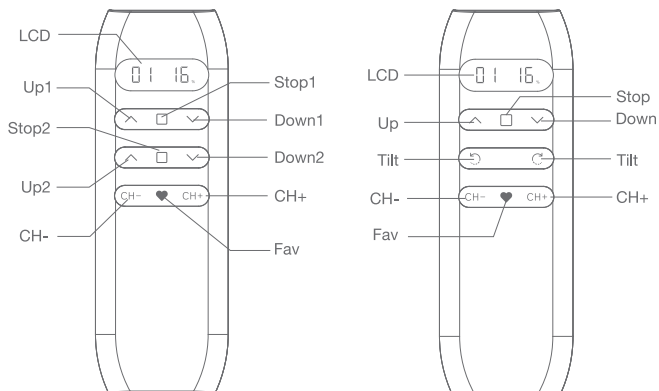

JCHR35W3C4
16-channel dual control LCD
remote controller

JCHR35W3C5
16-channel LCD
remote controller

02 Buttons

a. Front

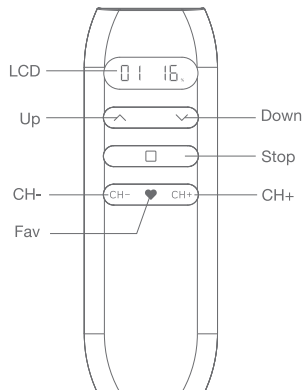

JCHR35W3C3
16-channel LCD
remote controller

b. Back

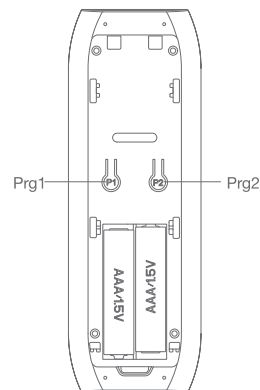

03 Parameters(more info please refer to the nameplate)

Electrical Specification	Standard
Battery Type	AAA battery*2
Working Temperature	-10℃-50℃
Radio Frequency	433.92M±100KHz
Transmit Distance	>=30m indoor

04 Caution!



- 1.The transmitter should not be exposed to moisture or impact, so as not to affect its life
- 2.During use, when the remote control distance is significantly shorter or less sensitive, please check whether the battery needs to be replaced.
- 3.When the voltage is too low, the LCD screen digital display will be weak, prompting to replace the battery.
- 4.Please properly dispose of used batteries according to the local garbage classification and recycling policy.

05 Instructions

a.Channels & Groups Toggling

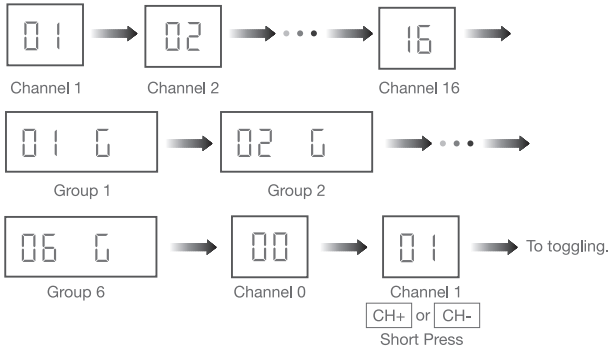

Note: Channel 0 is the group control for all the channels.

b.Number of Channels Setting

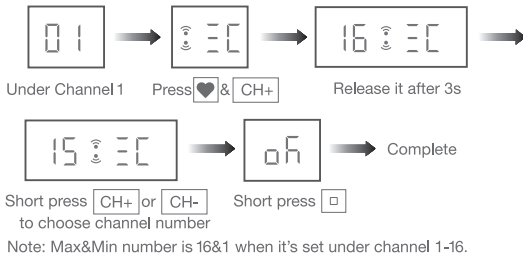

c.Number of Groups Setting

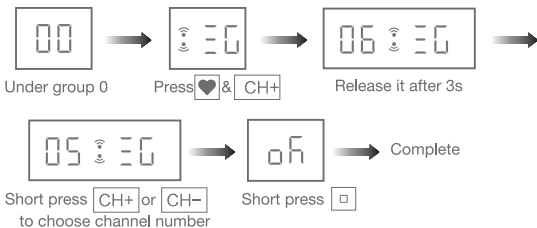

d.Channel in Group Setting

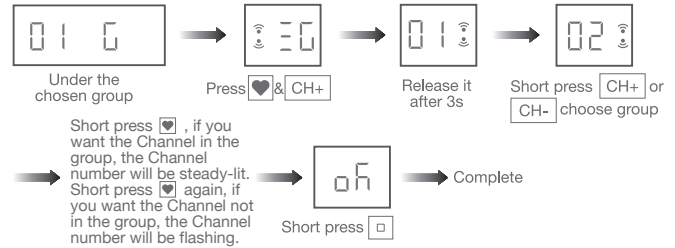

Note: Channel in groups setting is under GROUP 1-6.

e.Check the Channels in Groups

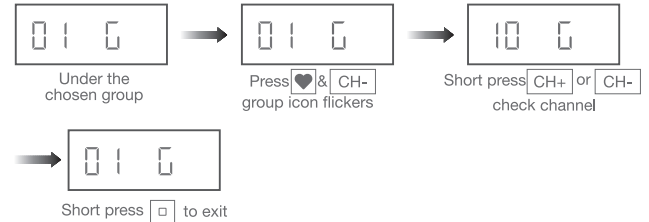

f.Prohibit Dual-key Operation

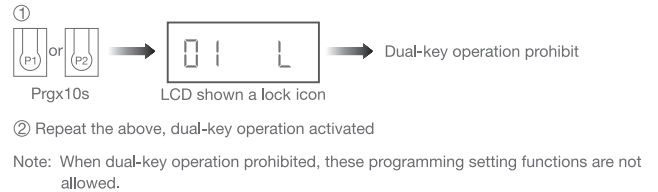

g.Position Percent Setting

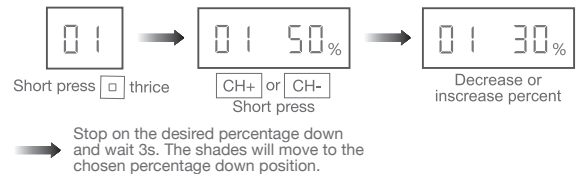

Note: All the shades after same group will run to same position after percent setting.

n.For other operations, please refer to the motor operation instruction