

JCHR35W3A1/2/3/4

Remote Controller

User Manual

02 Buttons

a.Front

01 Product Info

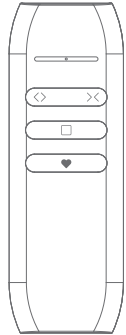

JCHR35W3A1

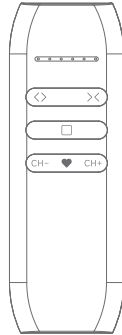

JCHR35W3A2

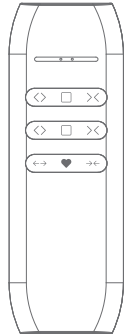

JCHR35W3A3

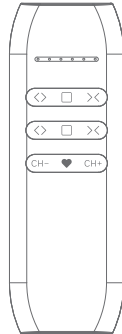

JCHR35W3A4

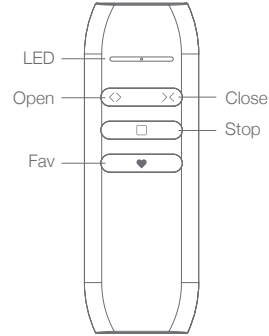

JCHR35W3A1
Single channel remote controller

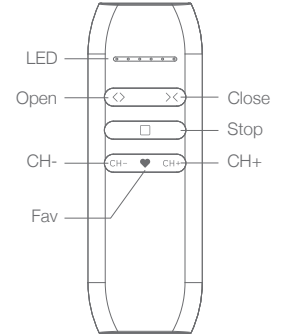

JCHR35W3A2
6-channel remote controller

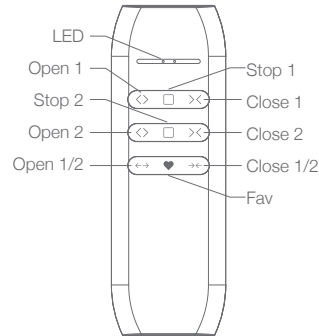

JCHR35W3A3
Single channel dual control remote controller

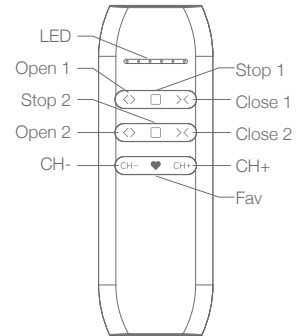

JCHR35W3A4
6-channel dual control remote controller

b.Back

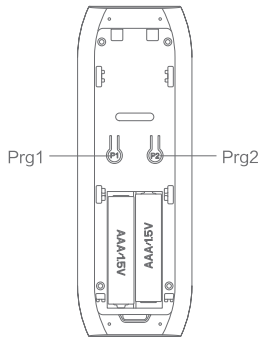

03 Parameters(more info please refer to the nameplate)

Electrical Specification	Standard
Battery Type	AAA battery*2
Working Temperature	-10℃-50℃
Radio Frequency	433.92M±100KHz
Transmit Distance	>=30m indoor

04 Caution!



- 1.The transmitter should not be exposed to moisture or impact, so as not to affect its life
- 2.During use, when the remote control distance is significantly shorter or less sensitive, please check whether the battery needs to be replaced.
- 3.When the battery voltage is too low, orange LED flickers when you press button, indicating to replace battery.
- 4.Pls properly dispose of used batteries according to the local garbage classification and recycling policy.

05 Instruction

a. Prohibit Dual-key Operation



Note: When dual-key operation prohibited, these programming setting functions are not allowed, such as limits setting.

b. Number of Channels Setting (Only apply to JCHR35W2A2、JCHR35WA4)

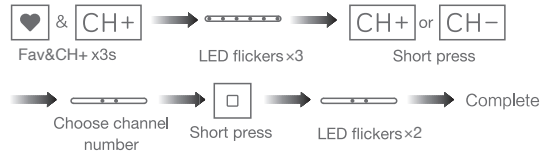

Note: When all LEDs are lit, that is channel 0 (All channels move together).

c. For other operations, pls refer to the motor user manual