

JCD-LW1-TY

Wireless Wi-Fi Connecting Module User Manual

01 Product Info



- Working voltage: 3V~3.6V
- Supporting protocol: 802.11B/G/N20
- Certification: CE, FCC
- Working Temperature: -10°C~55°C
- For Indoor Use only

02 Application

This module equips those common RF motors with the capacity to connect to the local network, enabling them to work with nearby smart speakers and other devices. The Wi-Fi module can converse with various smart home platforms, including Xiaomi, Tmall, Alexa, etc.

03 Installation&Connecting to Wi-Fi network

*Connection requirement

Make sure the Wi-Fi module and smart phone be connected to the same Wi-Fi network. The smart phone needs to connect to Wi-Fi network and turn on the Bluetooth function first.

① Download APP

a. Search "Smart Life" in the app store or scan the following QR code



Smart Life

b. Complete account registration and login to the app

② Add Device

a. Power on, insert module to motor head

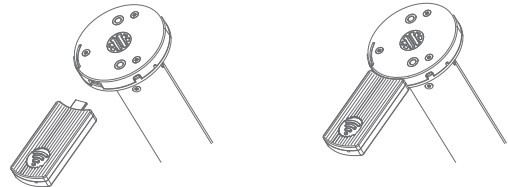

b. Wait for 10s to see if the indicator is blinking

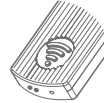

c. If indicator didn't blink, pls try:

Method 1: Long insert RESET button until indicator blinking, motor's ready to Wi-Fi connection

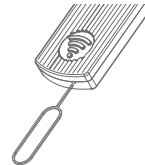

Note: You can try Method 2 if it is not easy to insert RESET on module

Method 2: Short Press Prg on back of controller, motor jogs once; short press Down, motor jogs once, then short press UP, motor jogs once and blue indicator blinks which means motor enters Wi-Fi connection status.

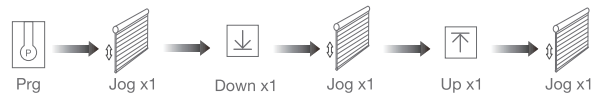

d. Click "+" in the upper right corner of the APP, then click "Auto Scan", the APP will automatically search for tubular motor

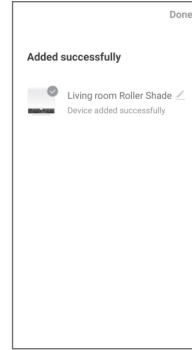
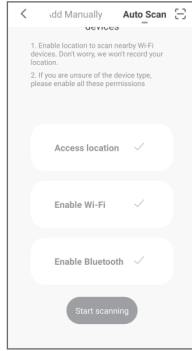
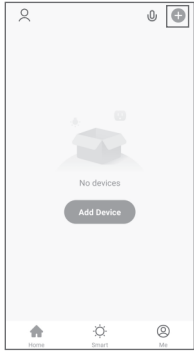

e. Click "Next" when you find the device, enter the Wi-Fi account password and click "Confirm" to connect.

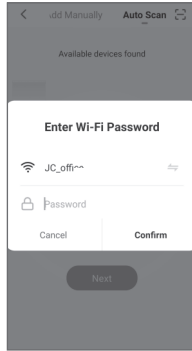

g. The Wi-Fi module indicator is always on after successful network connection.

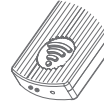

h. Enter the main interface to control the operation of the roller shade.

f. After adding device successfully, tap "✎" after the device name to modify the device name.

